

FOR LEASE

Fourth Plain Business Park II

15100 NE 65th Avenue
Vancouver, WA 98682

PACIFIC NW
PNW PROPERTIES



LOCATION

- Corner of Fourth Plain Blvd and NE 152nd Ave (& 65th Ave)
- Adjacent to the Walmart & Retail Development
- 3 minutes to SR 500; 5 minutes to I-205
- Close to amenities: Vancouver Mall, Walmart, food, shopping, fitness & hotels.

PROJECT HIGHLIGHTS

- Brand new construction with modern finishes
- Spaces for lease in the 3,000 – 16,000 SF range
- Dock and Grade loading doors
- 18' ceiling clear height
- Fire sprinklered
- Highly-prominent & visible monument sign positions available
- Well-maintained, professional setting
- Locally-owned and managed
- Please call for competitive pricing and more info

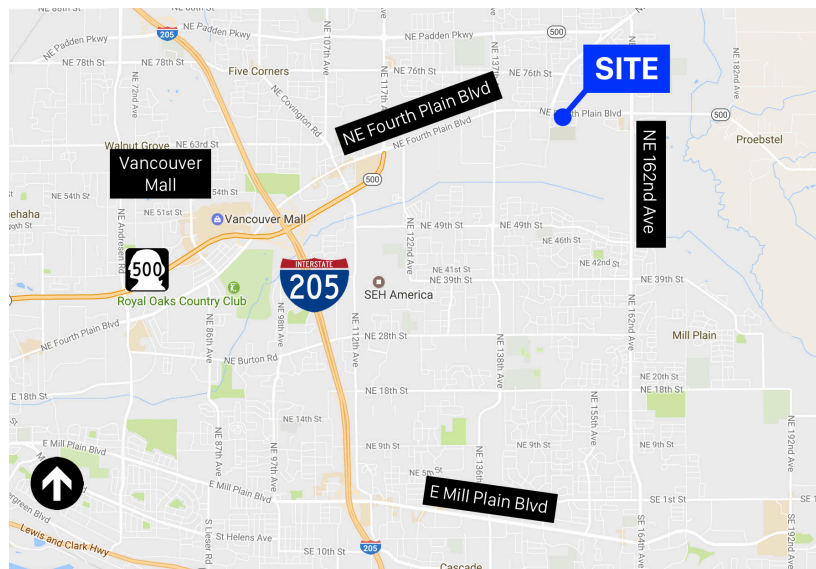

For more information, please contact:

Mitch Page or Evan Bernstein
(503) 626-3500

mitch.page@pnwprop.com

evan.bernstein@pnwprop.com

pnwprop.com

The information contained herein is believed to be accurate but is not warranted as to its accuracy and may change or be updated without notice.

FOR LEASE

Fourth Plain Business Park II

15100 NE 65th Avenue
Vancouver, WA 98682

PACIFIC NW
PNW PROPERTIES

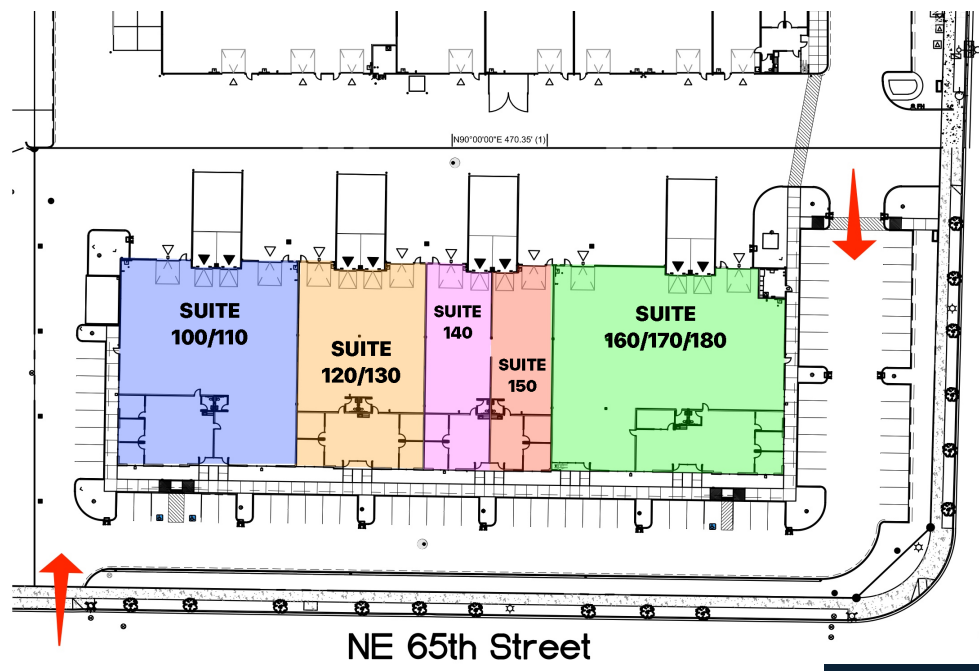

NE 152nd Ave

NE 65th Street

- SUITE 100/110**
 - SHELL: 10,134 SF
 - OFFICE: 1,891 SF
- SUITE 120/130**
 - SHELL: 7,252 SF
 - OFFICE: 2,005 SF
- SUITE 140**
 - SHELL: 3,756 SF
 - OFFICE: 1,043 SF
- SUITE 150**
 - SHELL: 3,509 SF
 - OFFICE: 976 SF
- SUITE 160/170/180**
 - SHELL: 12,958 SF
 - OFFICE: 2,514 SF

Note: bay sizes subject to minor change

For more information, please contact:
Mitch Page or Evan Bernstein
(503) 626-3500
mitch.page@pnwprop.com
evan.bernstein@pnwprop.com

Fourth Plain Business Park II
Vancouver

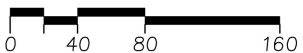

pnwprop.com

The information contained herein is believed to be accurate but is not warranted as to its accuracy and may change or be updated without notice.